

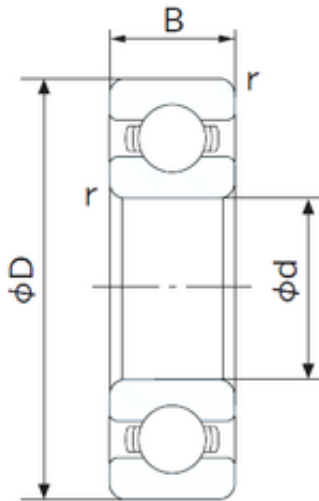

BEARING PRECISION AXLE CORP.



45 mm x 85 mm x 19 mm EGF35260-E40 Plain Bearings 35x39x26mm

Bearing No. 6209

6209 Bearing 2D drawings and 3D CAD models

Size	45x85x19 mm
Bore Diameter	45 mm
Outer Diameter	85 mm
Width	19 mm
d	45 mm
D	85 mm
B	19 mm
C	19 mm
r min.	1.1 mm
da min.	52 mm
Da max.	78 mm
ra max.	1.0 mm
Weight	0.407 Kg
Basic dynamic load rating (C)	32,5 kN
Basic static load rating (C0)	20,5 kN
(Grease) Lubrication Speed	7600 r/min
Category	Single Row Ball Bearings
Inventory	0.0
Manufacturer Name	NACHI
Minimum Buy Quantity	N/A
Weight / Kilogram	0
Product Group	B00308
Enclosure	Open
Precision Class	ABEC 1 ISO P0
Maximum Capacity / Filling	No



BEARING PRECISION AXLE CORP.

Slot	
Rolling Element	Ball Bearing
Snap Ring	No
Internal Special Features	No
Cage Material	Steel
Internal Clearance	C0-Medium
Inch - Metric	Metric
Long Description	45MM Bore; 85MM Outside Diameter; 19MM Outer Race Width; Open; Ball Bearing; ABEC 1 ISO P0; No Filling Slot; No Snap Ring; No Internal Special Features; C0-Medium Internal Clearance; Steel Cage
Other Features	Deep Groove
Category	Single Row Ball Bearing
UNSPSC	31171504
Harmonized Tariff Code	8482.10.50.68
Noun	Bearing
Keyword String	Ball
Manufacturer URL	http://www.nachiamerica.com
Weight / LBS	0.92
Outer Race Width	0.748 Inch 19 Millimeter
Inner Race Width	0 Inch 0 Millimeter
Bore	1.772 Inch 45 Millimeter
Outside Diameter	3.346 Inch 85 Millimeter
Bore Type	Cylindrical Bore
Configuration	Single Row
Bore Size	45 mm
Width	19 mm
Fillet Radius/Chamfer	1.1 mm
Dynamic Load Rating	32,500 N



BEARING PRECISION AXLE CORP.

Static Load Rating	20,500 N
Limiting Speed - Grease	7,800 rpm
Limiting Speed - Oil	9,300 rpm
Factor f_0	14.1
Radial Clearance	0.006 to 0.023 mm
da (min)	52 mm
Da (max)	78 mm
ra (max)	1 mm